

HM2D4

- Nickel plated alloy steel IP68 spoke type load cell
- Tension and compression applications
- Suitable for truck scales, hopper scales, automobile testing facilities and other electronic weighing or force measuring field.



Available models

Capacity	Accuracy	Full article description
0.5t~10t	C3	HM2D4-C3-xxt-5B6
20t	G1	HM2D4-G1-20t-5B6
50t	G3	HM2D4-G3-50t-5B6

Specification

Accuracy class		C3	G1	G3
Maximum capacity (E_{max})	t	0.5/1/2/3/5/10	20	50
Ratio of minimum LC verification interval $Y = E_{max} / v_{min}$	v_{min}	7500		
Combined error	%FS	0.02	0.1	0.3
Creep	%FS/30min	± 0.016	± 0.05	± 0.1
Temperature effect on sensitivity	%FS/10°C	± 0.011	± 0.1	± 0.2
Temperature effect on zero	%FS/10°C	± 0.019	± 0.1	± 0.2
Output sensitivity (= FS)	mV/V	2.0 ± 0.002		
Input resistance	Ω	350 ± 3.5		
Output resistance	Ω	350 ± 3.5		
Insulation resistance	MΩ	≥ 5000(50VDC)		
Zero balance	%FS	0~1.0		
Compensated temperature	°C	-10~+40		
Operating temperature	°C	-35~+65		
Excitation, recommended voltage	V	5~12(DC)		
Excitation maximum	V	18(DC)		
Safe overload	of E_{max}	150		
Ultimate overload	of E_{max}	300		

Dimensions in mm

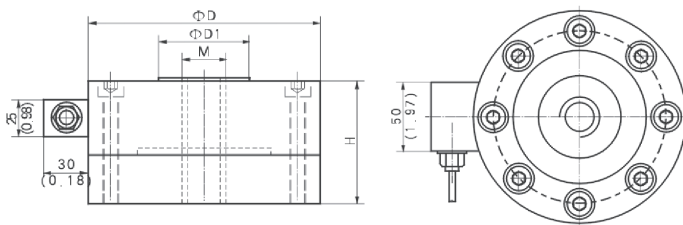

Dimension	D	D1	H	M
Capacity				
0.5t~2t	105 (4.13)	28 (1.10)	70 (2.76)	M14 × 2
3t, 5t	120 (4.72)	33 (1.3)	80 (3.15)	M20 × 1.5
10t, 20t	155 (6.10)	60.5 (2.38)	90 (3.54)	M32 × 2
50t	200 (7.87)	75 (2.95)	120 (4.72)	M45 × 3

Wiring

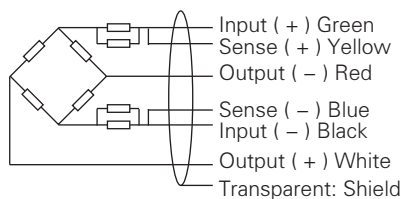

- Shielded, 6 conductor cable: Φ5.6mm
- Standard cable length: 5m